



i-6 POI

RGBW LED Wash Light



Description

The i-6 is a narrow-beam wash which provides long-throw performance. Its tight beam can deliver a remarkable amount of light and powerful colors exactly where needed, reaching the furthest parts of your installation, while avoiding light pollution. It is a single-head, compact LED luminaire that establishes a new benchmark for wall washing and accent lighting, thanks to its advanced optical design.

Features and benefits

- ✓ Powerful RGBW LED wash light
- ✓ Native 2.3° and optional 3.2° x 3.4° beam angle
- ✓ Ideal application: Long distances
- ✓ Compact, lightweight and maintenance-free
- ✓ Color temperature control from 2,000K to 10,000K
- ✓ Smooth dimming performance and dynamic color change
- ✓ IP66-rated with built-in dehumidifier and superior thermal management
- ✓ 5-year warranty in corrosion class C5-M (marine)

Certifications & classifications

IP66

RoHS



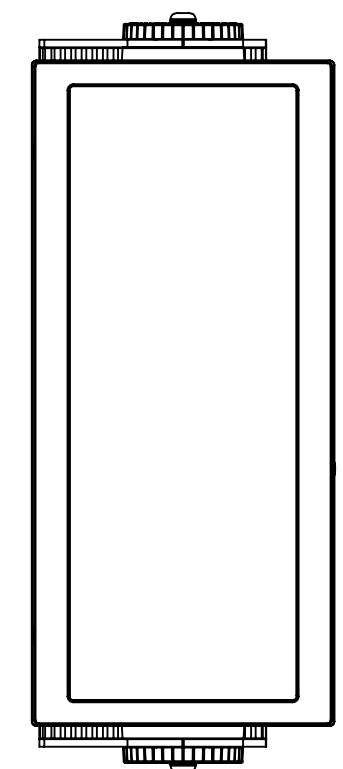
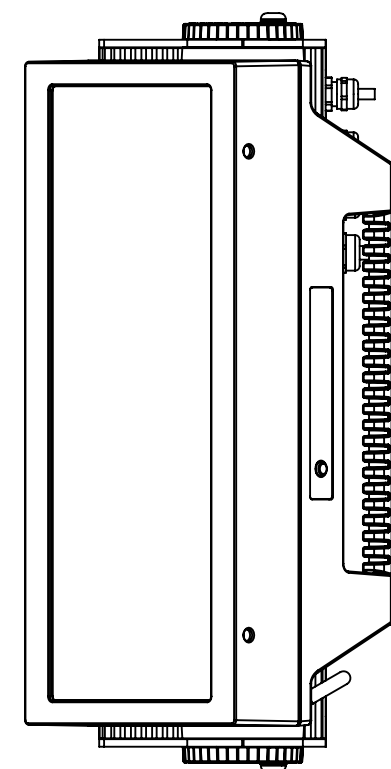
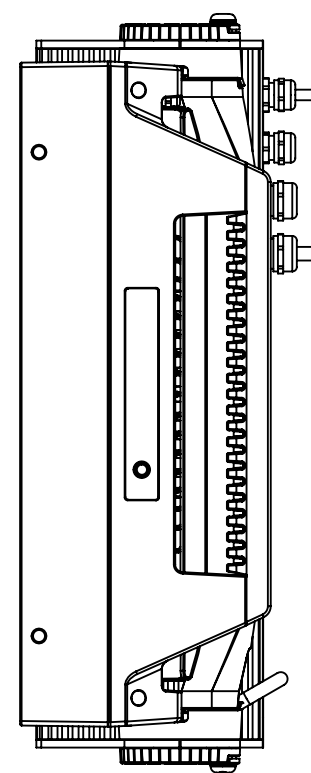
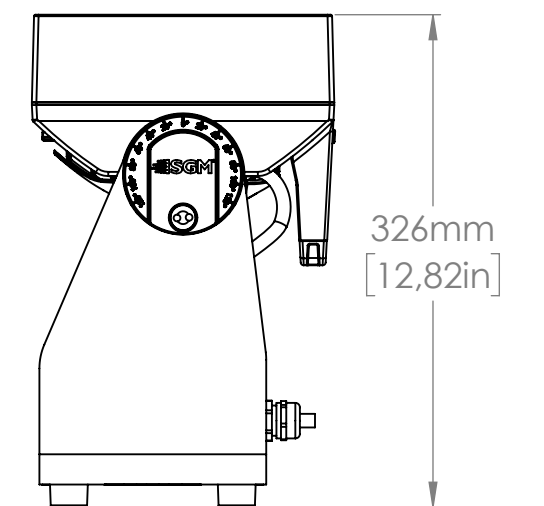
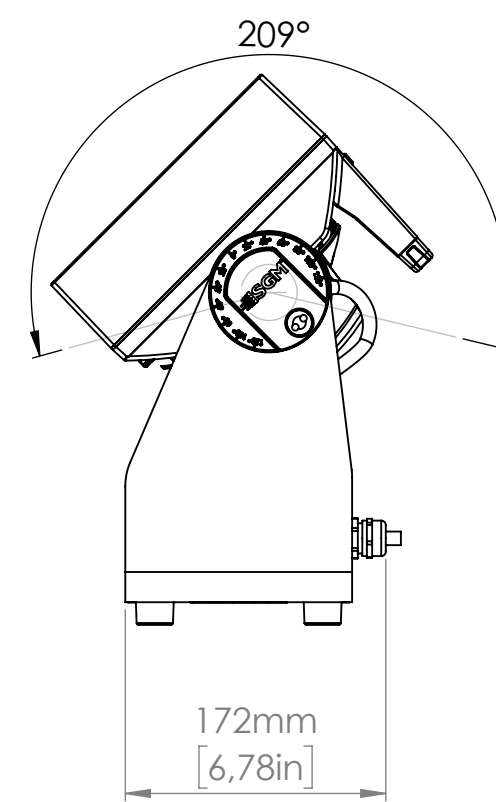
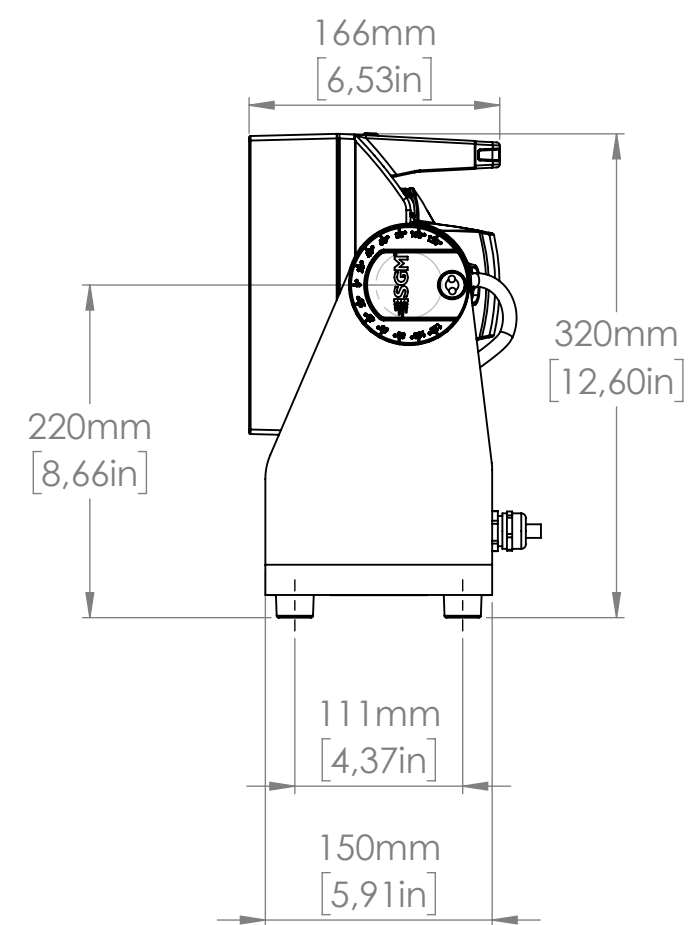
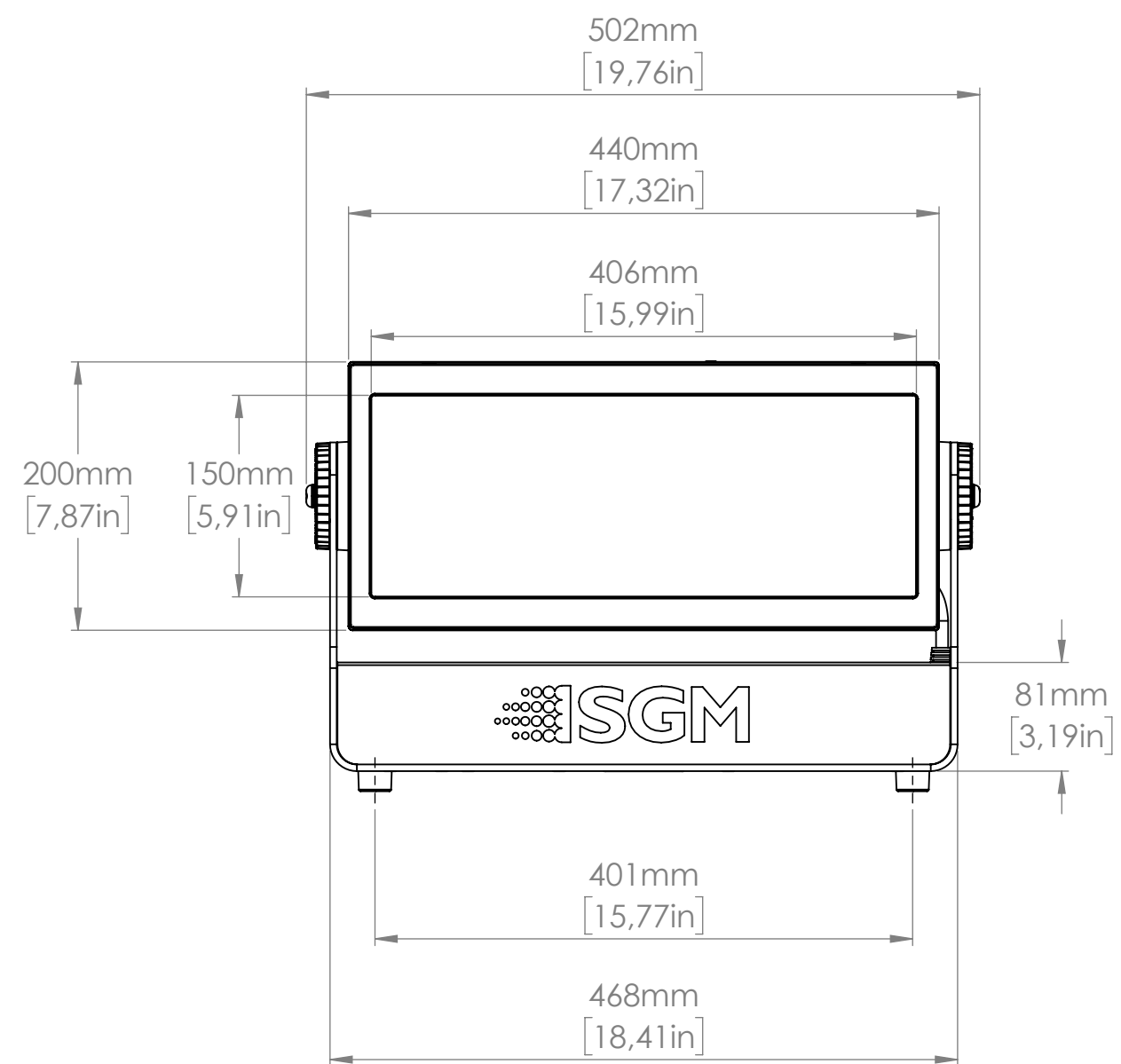

Specification

Optical Data	LED expected lifetime	50,000 hours
	Lightsource	24 LEDs total, 5 Red, 5 Green, 5 Blue, 9 White
	Native lens options	2.3°
	Optional filters	3.2° x 3.4°, internal
Photometric	Color temperature range	2000K - 10000K
	Efficacy	10 lm/W
	Light output all LEDs on	2615 lm
	Lumen per kilogram	174 lm / Kg
	Lux @ 10m	14176 lux
	Lux @ 3m	157516 lux
	Lux @ 5m	56706 lux
	Native beam angle(s)	2.3°
	Native field angle(s)	4.2°
Physical	Preliminary light output all LEDs on	2615 lm
	Color options	Black - RAL 9004 Custom color - Any RAL White - RAL 9010
	Corrosion class	CX (C5-M - ISO 12944)
	Effective Projected Area	1.79 Square ft
	IK rating	IK06
	IP class	IP66
	Lens material	PMMA
	Material	Aluminium PC/ASA Rubber Steel Tempered Glass
	Net dimensions	497 x 166 x 305 mm
	Net dimensions inches	19.6 x 6.5 x 12 inches
Features	Net weight	15 kg (33.1 lbs)
	Color calibration	SGM proprietary, full color calibration
	Dehumidifier	Base / Head
	Dimming	12 DMX-controllable curves (smooth fade in / fast response / low-end extended range)
	Emulation mode / effect	Tungsten response emulation Color Filter Emulation Built-in color presets, display

	Other	selectable Studio DMX mode(s) Versapath color engine LED frequency control over DMX
	Power / DMX indicator	Head
	Tilt	209°
	Tilt locking system	POI Locking system with pignose bolts and angle indicator
Electrical	Electrical protection	Overload protection with automatic recover
	Input voltage, absolute max. rating	90 - 305 VAC; 50 / 60 Hz
	Input voltage, nominal	100 - 277 VAC; 50 / 60 Hz
	Max inrush current 230VAC	70 A
	Max power consumption	250 W
	Max power thru @ 100 V	17 A
	Max power thru @ 230 V	14 A
	Power factor	0.92 PF (230 V)
	Power Supply Unit	Inbuilt IP 67 Auto-ranging electronic switch-mode
	Standby power consumption	7 W
Programming and Control	16-bit control	Dimmer, Red, Green, Blue, White
	DMX channels	3, 4, 6, 8, 10, 22
	DMX modes	6
	Protocol	CRMX, W-DMX™ G2, W-DMX™ G3, W-DMX™ G4, W-DMX™ G4S USITT DMX512A RDM ANSI E1.20
	Setting and addressing	RDM ANSI E1.20
	Standalone mode	Quick Color 3 programs with up to 24 scenes
	Wireless DMX	Lumen Radio with RDM
Connections	Data cable diameter	6,5 mm +/- 0,2 mm
	DMX data in/out	5 meter cable for DMX In and DMX Thru (permanently wired)
	Power	Power cable 5 meter with bare ends (permanently wired)
	Power cable diameter	8,5 mm +/- 0,3 mm
Installation	Mounting point	3 x 2 M-10 locking points (suitable for two or three optional POI Omega brackets)
	Orientation	Any

	Rigging possibilities	Hanging / horizontal mounted or ceiling / wall mount (optional)
	Safety features	Bottom mount for safety wire Minimum distance to combustible materials: 0.3 meter (11 in).
Thermal	Cooling	Active, Forced Air, Temperature-regulated
	Humidity (max.)	98 %
	Thermal protection	Automatic overtemperature protection
	Total heat dissipation, max power	853 BTU per hour
	Total heat dissipation, standby	23.9 BTU per hour
Included items	Included items	Safety instructions and installation quick guide 6 M-10 screws
Conforms To	CE - 2014/30/EU: EMC Directive	EN 55103-2 EN 55015 EN 61547 EN 61000-3-2 EN 61000-3-3 EN 55032
	CE - 2014/35/EU: Low Voltage Directive	EN 60598-1 EN 60598-2-17 EN 62471 EN 60529
	RoHS2 Directive	2011/65/EU

NOTES:

Due to continuous improvements and innovations, specifications may change without notice.

LEDs' expected lifetime provided by manufacturer and obtained under manufacturer's test conditions.

Zoom range defined as a minimum beam angle to a maximum field angle.

Photometric measurements obtained with Goniometer Scan / SGM Illumination Lab 1.6.0.0.

Lumen output in pixel products is calculated.

Ordering information

Qty	Product name	Item number
<input type="checkbox"/>	I-6 RGBW, 2.5°, POI, BL	80251775
<input type="checkbox"/>	I-6 RGBW, 2.5°, POI, WH	80251776
<input type="checkbox"/>	I-6 RGBW, 2.5°, POI, CU	80251777
<input type="checkbox"/>	I-6 RGBW, 3.4°, POI, BL	80251790
<input type="checkbox"/>	I-6 RGBW, 3.4°, POI, WH	80251791
<input type="checkbox"/>	I-6 RGBW, 3.4°, POI, CU	80251792
<input type="checkbox"/>		
Accessories		Item number
<input type="checkbox"/>	Vacuum Test Kit	83061136
<input type="checkbox"/>	Omega Bracket POI	83060623
<input type="checkbox"/>	Anti-glare shield, full - Medium, POI, P-6 / Q-8 / i-6	83061176
<input type="checkbox"/>	SGM USB uploader cable, POI	83062067
<input type="checkbox"/>		



Headquarter [+45 70 20 74 00](tel:+4570207400)

Mail info@sgmlight.com

Website sgmlight.com