



XS Wireless Digital

Instruction Manual

Sennheiser electronic GmbH & Co. KG

SENNHEISER

Am Labor 1, 30900 Wedemark, Germany, www.sennheiser.com
XS Wireless Digital - v2.1

XLR BASE SET



LAVALIER SET



PRESENTATION BASE SET



XLR BASE SET



INSTRUMENT BASE SET



PEDALBOARD SET



**PORTABLE
INTERVIEW SET**



**PORTABLE
LAVALIER SET**



PORTABLE ENG SET



**PORTABLE
BASE SET**





VOCAL SET

Package contents



Additional information

- 1** Microphone clamp for fastening the vocal microphone to a stand
- 2** XSW Digital TX XLR: transmitter (female XLR socket) for connecting to the vocal microphone



- 3** XSW Digital RX XLR: receiver (male XLR plug) for connecting to a mixing console



- 4** Charging cable (USB-A to USB-C) for charging the transmitter and receiver
- 5** XS 1: vocal microphone
- 6** Stickers for labeling transmission paths



Operation

Connecting the transmitter to the vocal microphone



- ▷ Plug the transmitter into the XLR socket on the vocal microphone.

Connecting the receiver to a mixing console

- ▷ Plug the receiver into the XLR input of a channel on your mixing console.



Holding the vocal microphone



- ▷ Grip the vocal microphone only by the handle.
- ▷ You can also use the microphone clamp to fasten the vocal microphone to a stand.
- ▷ Hold the microphone 5 to 10 cm in front of your mouth when singing.
- ▷ Do not grab the transmitter. The range may decrease if the transmitter is covered.
- ▷ Do not touch the microphone basket. The sound may be distorted if the microphone basket is covered.

Switching on the transmitter and receiver

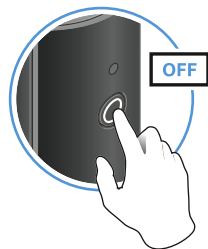

- ▷ Briefly press the button on the transmitter and the button on the receiver.
The status LEDs indicate the charge level for four seconds.
- ▷ During these four seconds, check that the transmitter and receiver are sufficiently charged.
 - > 75%
 - 5% – 75%
 - < 5%

If the status LED remains red, you should charge the rechargeable battery first. If the status LED flashes red, the charge level is too low. You have to charge the rechargeable battery first (see „Charging the rechargeable battery“).



After four seconds, the status LED starts flashing green. The flashing indicates that a wireless connection is being established.

The status LEDs remain green once the transmitter and receiver are connected. If the status LEDs do not remain green, either the charge level is below 15% (see „Checking the charge level during use“) or the transmitter and receiver are not paired (see „Pairing“).

Switching off the transmitter and receiver

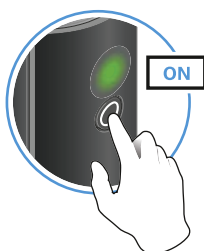

- Press the button on the transmitter and the button on the receiver until the status LEDs switch off.

Muting the audio signal

When using a set, you can mute the audio signal. The audio signal can then be unmuted.

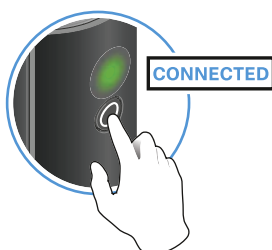

- To mute the audio signal: Briefly press the button on the transmitter or receiver.

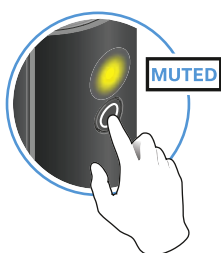

- To unmute the audio signal: Briefly press the button on the transmitter or receiver.



Checking the charge level during use

The status LED remains green during use as long as the rechargeable battery has sufficient charge. The status LED begins flashing red and green in alternation when the charge level falls below 15%. Once the charge level falls below 5%, the status LED flashes only red.

In addition to the local charge level, the status LED on a transmitter or receiver also provides information about the charge level of the connected transmitter or receiver. This allows you to check the charge levels at any time.



The charge level is below 15%.



The charge level of the **connected** transmitter/receiver is below 15%.



The charge level is below 5%.



The charge level of the **connected** transmitter/receiver is below 5%.





Charging the rechargeable battery

To minimize charging time and monitor the charging status the transmitter or receiver should be switched off before you charge the battery.

However the transmitter or receiver can be charged while in operation.

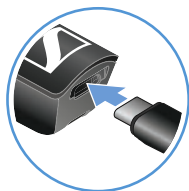

- ▷ Plug the small end of the USB charging cable into the USB port on the transmitter or receiver.
- ▷ Plug the large end of the USB charging cable into the USB port on a conventional USB power supply unit.
- ▷ Plug the USB power supply unit into the wall socket.

The status LED indicates the charge level.

- < 5%
- 5% – 75%
- > 75%
- 100%

Using stickers to label transmission paths

You can use the colored stickers to show which transmitter belongs to which receiver.

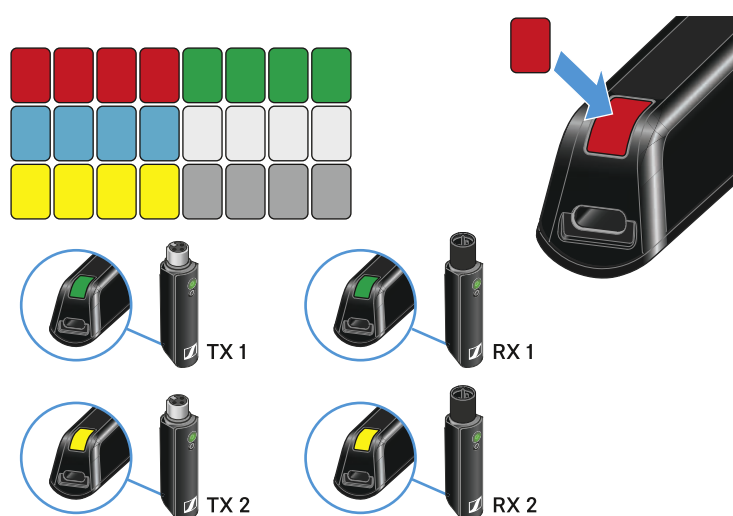



Pairing

The transmitter and the receiver of a set are pre-paired at the factory and therefore ready for immediate use. The wireless connection is established once the transmitter and receiver are switched on and within range of each other.

You can pair up to four transmitters to the receiver.

Please note that you can only use one transmitter at a time. The other paired transmitters must be switched off in the meantime.

- ▷ Make sure that both the transmitter and receiver are switched off.

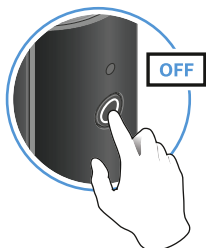

- ▷ Press the button on the transmitter and the button on the receiver until the status LEDs start flashing green and red in alternation.

The status LEDs will remain green once the transmitter and receiver are paired and connected. If the status LEDs do not remain green, the charge level is below 15% (see „Checking the charge level during use“).

Out-of-range monitoring

The status LEDs begin flashing red when the transmitter and receiver are almost out of range.

Correcting faults

If the status LED remains red, a fault has occurred.

- ▷ Unplug any connected USB cables from the UBS port.
- ▷ Switch the transmitter and receiver off and on again.
- ▷ Perform pairing, if necessary.
- ▷ If this does not correct the fault, please contact Sennheiser customer service:
www.sennheiser.com/service-support



LAVALIER SET

Package contents

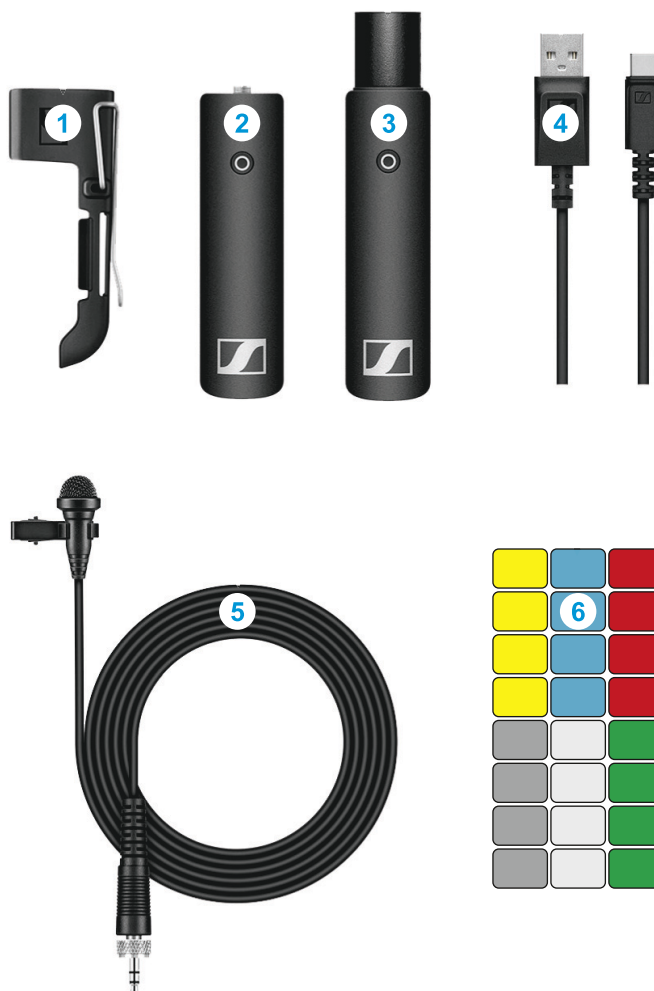

Additional information

- 1** Belt clip for the transmitter
- 2** XSW Digital TX 35: transmitter (3.5 mm jack socket) for connecting to the clip-on microphone



- 3** XSW Digital RX XLR: receiver (male XLR plug) for connecting to a mixing console



- 4** Charging cable (USB-A to USB-C) for charging the transmitter and receiver
- 5** ME 2-2: clip-on microphone
- 6** Stickers for labeling transmission paths



Operation

Connecting the clip-on microphone to the transmitter

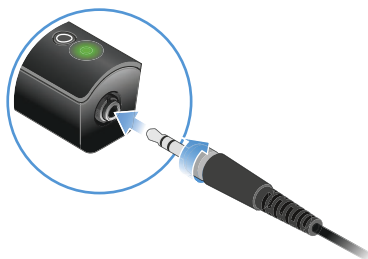

- ▷ Plug the clip-on microphone's screw-on jack plug into the jack socket on the transmitter.
- ▷ Lock the jack plug by screwing down the coupling ring.
If the jack plug is not firmly locked, crackling noise can appear in the audio signal.
- ▷ Insert the transmitter into the belt clip.
- ▷ Fasten the belt clip to your clothes, for example on your belt or waistband.

Attaching the clip-on microphone

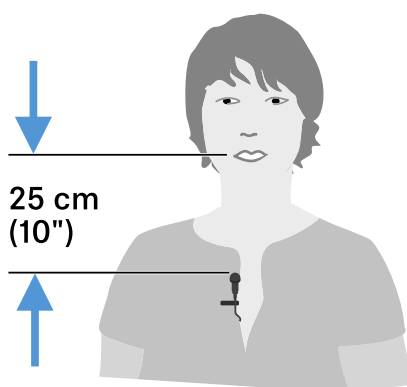

- ▷ Fasten the clip-on microphone to your clothes, for example on your collar or lapel.
- ▷ The distance to your mouth should be about 25 cm. The distance affects the sensitivity of the clip-on microphone. Reduce the distance if you are speaking at a low volume, and increase it when speaking loudly.



Connecting the receiver to a mixing console

- ▷ Plug the receiver into the XLR input of a channel on your mixing console.

Switching on the transmitter and receiver

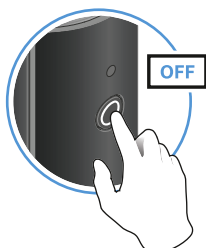

- ▷ Briefly press the button on the transmitter and the button on the receiver.
The status LEDs indicate the charge level for four seconds.
- ▷ During these four seconds, check that the transmitter and receiver are sufficiently charged.
 - > 75%
 - 5% – 75%
 - < 5%

If the status LED remains red, you should charge the rechargeable battery first. If the status LED flashes red, the charge level is too low. You have to charge the rechargeable battery first (see „Charging the rechargeable battery“).

After four seconds, the status LED starts flashing green. The flashing indicates that a wireless connection is being established.

The status LEDs remain green once the transmitter and receiver are connected. If the status LEDs do not remain green, either the charge level is below 15% (see „Checking the charge level during use“) or the transmitter and receiver are not paired (see „Pairing“).

Switching off the transmitter and receiver

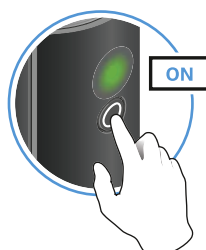

- ▷ Press the button on the transmitter and the button on the receiver until the status LEDs switch off.



Muting the audio signal

When using a set, you can mute the audio signal. The audio signal can then be unmuted.

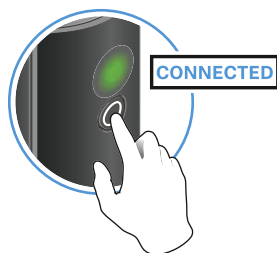

- ▶ To mute the audio signal: Briefly press the button on the transmitter or receiver.
-

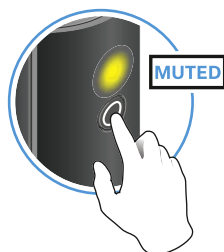

- ▶ To unmute the audio signal: Briefly press the button on the transmitter or receiver.



Checking the charge level during use

The status LED remains green during use as long as the rechargeable battery has sufficient charge. The status LED begins flashing red and green in alternation when the charge level falls below 15%. Once the charge level falls below 5%, the status LED flashes only red.

In addition to the local charge level, the status LED on a transmitter or receiver also provides information about the charge level of the connected transmitter or receiver. This allows you to check the charge levels at any time.



The charge level is below 15%.



The charge level of the **connected** transmitter/receiver is below 15%.



The charge level is below 5%.



The charge level of the **connected** transmitter/receiver is below 5%.





Charging the rechargeable battery

To minimize charging time and monitor the charging status the transmitter or receiver should be switched off before you charge the battery.

However the transmitter or receiver can be charged while in operation.

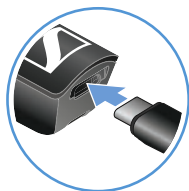

- ▷ Plug the small end of the USB charging cable into the USB port on the transmitter or receiver.
- ▷ Plug the large end of the USB charging cable into the USB port on a conventional USB power supply unit.
- ▷ Plug the USB power supply unit into the wall socket.

The status LED indicates the charge level.

- < 5%
- 5% – 75%
- > 75%
- 100%

Using stickers to label transmission paths

You can use the colored stickers to show which transmitter belongs to which receiver.

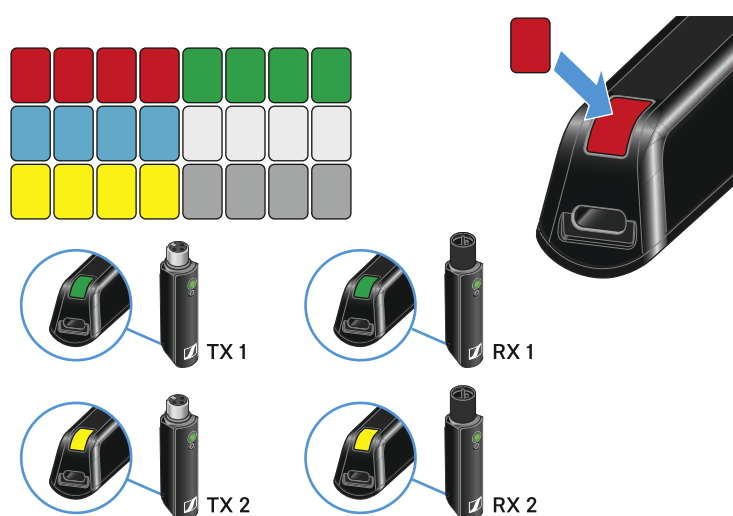



Pairing

The transmitter and the receiver of a set are pre-paired at the factory and therefore ready for immediate use. The wireless connection is established once the transmitter and receiver are switched on and within range of each other.

You can pair up to four transmitters to the receiver.

Please note that you can only use one transmitter at a time. The other paired transmitters must be switched off in the meantime.

- ▷ Make sure that both the transmitter and receiver are switched off.

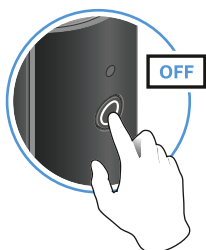

- ▷ Press the button on the transmitter and the button on the receiver until the status LEDs start flashing green and red in alternation.

The status LEDs will remain green once the transmitter and receiver are paired and connected. If the status LEDs do not remain green, the charge level is below 15% (see „Checking the charge level during use“).

Out-of-range monitoring

The status LEDs begin flashing red when the transmitter and receiver are almost out of range.

Correcting faults

If the status LED remains red, a fault has occurred.

- ▷ Unplug any connected USB cables from the UBS port.
- ▷ Switch the transmitter and receiver off and on again.
- ▷ Perform pairing, if necessary.
- ▷ If this does not correct the fault, please contact Sennheiser customer service:
www.sennheiser.com/service-support



PRESENTATION BASE SET

Package contents



Additional information

- 1** Belt clip for the transmitter
- 2** XSW Digital TX 35: transmitter (3.5 mm jack socket) for connecting to a microphone with a jack plug (3.5 mm)



- 3** XSW Digital RX XLR: receiver (male XLR plug) for connecting to a mixing console



- 4** Charging cable (USB-A to USB-C) for charging the transmitter and receiver
- 5** Stickers for labeling transmission paths



Operation

Connecting the microphone to the transmitter

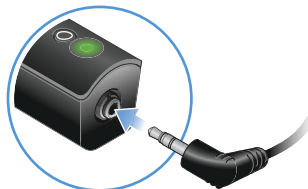

- ▷ Plug your microphone's jack plug into the jack socket on the transmitter.
- ▷ Insert the transmitter into the belt clip.
- ▷ Fasten the belt clip to your clothes, for example on your belt or waistband.

Connecting the receiver to a mixing console

- ▷ Plug the receiver into the XLR input of a channel on your mixing console.

Switching on the transmitter and receiver

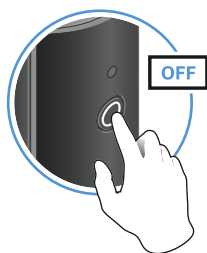

- ▷ Briefly press the button on the transmitter and the button on the receiver.
The status LEDs indicate the charge level for four seconds.
- ▷ During these four seconds, check that the transmitter and receiver are sufficiently charged.

- > 75%
- 5% – 75%
- < 5%

If the status LED remains red, you should charge the rechargeable battery first. If the status LED flashes red, the charge level is too low. You have to charge the rechargeable battery first (see „Charging the rechargeable battery“).

After four seconds, the status LED starts flashing green. The flashing indicates that a wireless connection is being established.

The status LEDs remain green once the transmitter and receiver are connected. If the status LEDs do not remain green, either the charge level is below 15% (see „Checking the charge level during use“) or the transmitter and receiver are not paired (see „Pairing“).



Switching off the transmitter and receiver

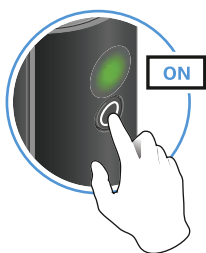

- ▷ Press the button on the transmitter and the button on the receiver until the status LEDs switch off.

Muting the audio signal

When using a set, you can mute the audio signal. The audio signal can then be unmuted.

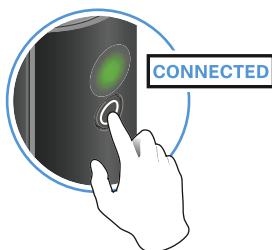

- ▷ To mute the audio signal: Briefly press the button on the transmitter or receiver.

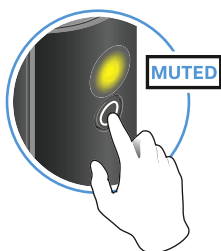

- ▷ To unmute the audio signal: Briefly press the button on the transmitter or receiver.



Checking the charge level during use

The status LED remains green during use as long as the rechargeable battery has sufficient charge. The status LED begins flashing red and green in alternation when the charge level falls below 15%. Once the charge level falls below 5%, the status LED flashes only red.

In addition to the local charge level, the status LED on a transmitter or receiver also provides information about the charge level of the connected transmitter or receiver. This allows you to check the charge levels at any time.



The charge level is below 15%.



The charge level of the **connected** transmitter/receiver is below 15%.



The charge level is below 5%.



The charge level of the **connected** transmitter/receiver is below 5%.





Charging the rechargeable battery

To minimize charging time and monitor the charging status the transmitter or receiver should be switched off before you charge the battery.

However the transmitter or receiver can be charged while in operation.

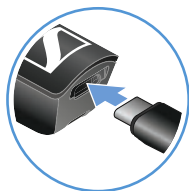

- ▷ Plug the small end of the USB charging cable into the USB port on the transmitter or receiver.
- ▷ Plug the large end of the USB charging cable into the USB port on a conventional USB power supply unit.
- ▷ Plug the USB power supply unit into the wall socket.

The status LED indicates the charge level.

- < 5%
- 5% – 75%
- > 75%
- 100%

Using stickers to label transmission paths

You can use the colored stickers to show which transmitter belongs to which receiver.

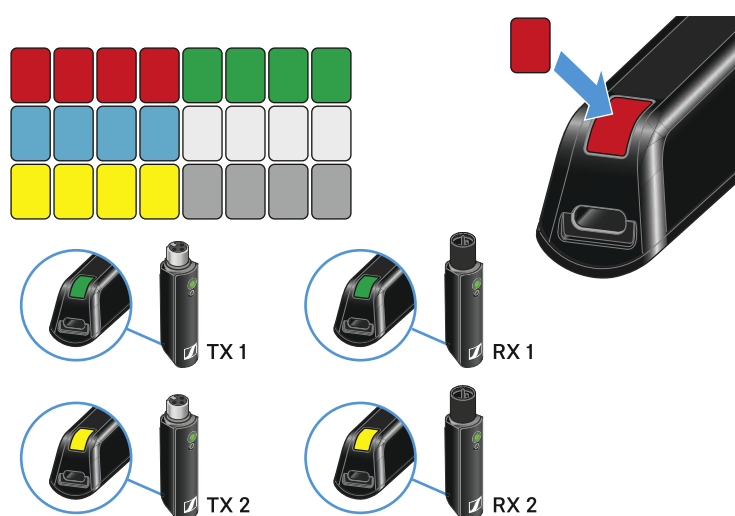



Pairing

The transmitter and the receiver of a set are pre-paired at the factory and therefore ready for immediate use. The wireless connection is established once the transmitter and receiver are switched on and within range of each other.

You can pair up to four transmitters to the receiver.

Please note that you can only use one transmitter at a time. The other paired transmitters must be switched off in the meantime.

- ▷ Make sure that both the transmitter and receiver are switched off.

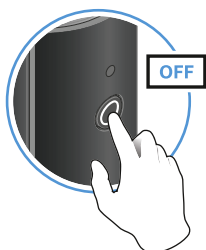

- ▷ Press the button on the transmitter and the button on the receiver until the status LEDs start flashing green and red in alternation.

The status LEDs will remain green once the transmitter and receiver are paired and connected. If the status LEDs do not remain green, the charge level is below 15% (see „Checking the charge level during use“).

Out-of-range monitoring

The status LEDs begin flashing red when the transmitter and receiver are almost out of range.

Correcting faults

If the status LED remains red, a fault has occurred.

- ▷ Unplug any connected USB cables from the USB port.
- ▷ Switch the transmitter and receiver off and on again.
- ▷ Perform pairing, if necessary.
- ▷ If this does not correct the fault, please contact Sennheiser customer service:
www.sennheiser.com/service-support



XLR BASE SET

Package contents



Additional information

- 1** XSW Digital TX XLR: transmitter (female XLR socket) for connecting to a microphone with an XLR plug (male)



- 2** XSW Digital RX XLR: receiver (male XLR plug) for connecting to a mixing console



- 3** Charging cable (USB-A to USB-C) for charging the transmitter and receiver
- 4** Stickers for labeling transmission paths



Operation

Connecting the transmitter to the microphone



- ▷ Plug the transmitter into the XLR socket on your microphone.

Connecting the receiver to a mixing console

- ▷ Plug the receiver into the XLR input of a channel on your mixing console.



Holding the microphone



- ▷ Grip the microphone only by the handle.
- ▷ Hold the microphone 5 to 10 cm in front of your mouth.
- ▷ Do not grab the transmitter. The range may decrease if the transmitter is covered.
- ▷ Do not touch the microphone basket. The sound may be distorted if the microphone basket is covered.

Switching on the transmitter and receiver

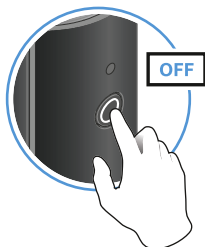

- ▷ Briefly press the button on the transmitter and the button on the receiver.
The status LEDs indicate the charge level for four seconds.
- ▷ During these four seconds, check that the transmitter and receiver are sufficiently charged.
 - > 75%
 - 5% – 75%
 - < 5%

If the status LED remains red, you should charge the rechargeable battery first. If the status LED flashes red, the charge level is too low. You have to charge the rechargeable battery first (see „Charging the rechargeable battery“).

After four seconds, the status LED starts flashing green. The flashing indicates that a wireless connection is being established.



The status LEDs remain green once the transmitter and receiver are connected. If the status LEDs do not remain green, either the charge level is below 15% (see „Checking the charge level during use“) or the transmitter and receiver are not paired (see „Pairing“).

Switching off the transmitter and receiver

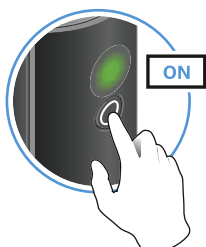

- ▷ Press the button on the transmitter and the button on the receiver until the status LEDs switch off.

Muting the audio signal

When using a set, you can mute the audio signal. The audio signal can then be unmuted.

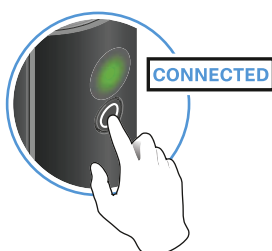

- ▷ To mute the audio signal: Briefly press the button on the transmitter or receiver.

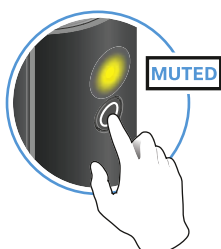

- ▷ To unmute the audio signal: Briefly press the button on the transmitter or receiver.



Checking the charge level during use

The status LED remains green during use as long as the rechargeable battery has sufficient charge. The status LED begins flashing red and green in alternation when the charge level falls below 15%. Once the charge level falls below 5%, the status LED flashes only red.

In addition to the local charge level, the status LED on a transmitter or receiver also provides information about the charge level of the connected transmitter or receiver. This allows you to check the charge levels at any time.



The charge level is below 15%.



The charge level of the **connected** transmitter/receiver is below 15%.



The charge level is below 5%.



The charge level of the **connected** transmitter/receiver is below 5%.





Charging the rechargeable battery

To minimize charging time and monitor the charging status the transmitter or receiver should be switched off before you charge the battery.

However the transmitter or receiver can be charged while in operation.

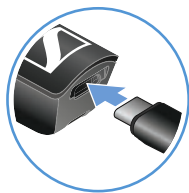

- ▷ Plug the small end of the USB charging cable into the USB port on the transmitter or receiver.
- ▷ Plug the large end of the USB charging cable into the USB port on a conventional USB power supply unit.
- ▷ Plug the USB power supply unit into the wall socket.

The status LED indicates the charge level.

- < 5%
- 5% – 75%
- > 75%
- 100%

Using stickers to label transmission paths

You can use the colored stickers to show which transmitter belongs to which receiver.

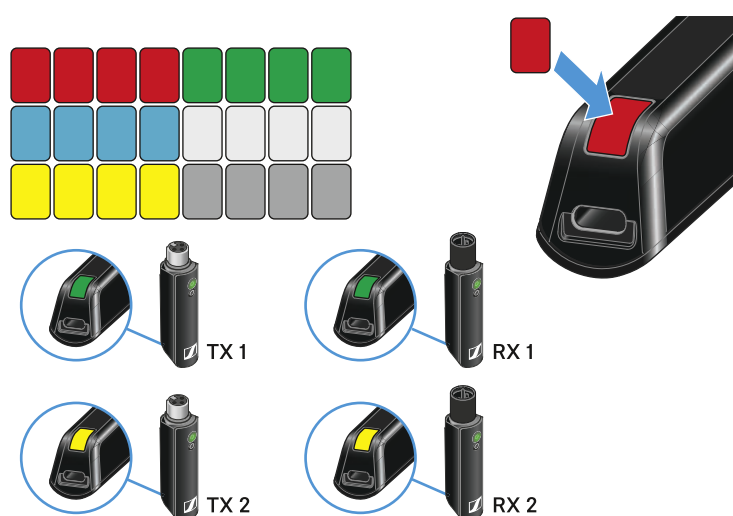



Pairing

The transmitter and the receiver of a set are pre-paired at the factory and therefore ready for immediate use. The wireless connection is established once the transmitter and receiver are switched on and within range of each other.

You can pair up to four transmitters to the receiver.

Please note that you can only use one transmitter at a time. The other paired transmitters must be switched off in the meantime.

- ▷ Make sure that both the transmitter and receiver are switched off.

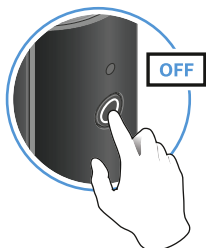

- ▷ Press the button on the transmitter and the button on the receiver until the status LEDs start flashing green and red in alternation.

The status LEDs will remain green once the transmitter and receiver are paired and connected. If the status LEDs do not remain green, the charge level is below 15% (see „Checking the charge level during use“).

Out-of-range monitoring

The status LEDs begin flashing red when the transmitter and receiver are almost out of range.

Correcting faults

If the status LED remains red, a fault has occurred.

- ▷ Unplug any connected USB cables from the USB port.
- ▷ Switch the transmitter and receiver off and on again.
- ▷ Perform pairing, if necessary.
- ▷ If this does not correct the fault, please contact Sennheiser customer service:
www.sennheiser.com/service-support



INSTRUMENT BASE SET

Package contents



Additional information

- 1** Belt clip for the transmitter
- 2** XSW Digital TX 63: transmitter (6.3 mm jack plug) for connecting to an instrument with a jack socket (6.3 mm) or to the extension cable



- 3** XSW Digital RX 63: receiver (6.3 mm jack plug) for connecting to an amplifier



- 4** Charging cable (USB-A to USB-C) for charging the transmitter and receiver
- 5** Extension cable (jack socket to jack plug, 6.3 mm)
- 6** Stickers for labeling transmission paths



Operation

Connecting the transmitter to an instrument

You can connect the transmitter either directly to your instrument or using the extension cable and the belt clip.

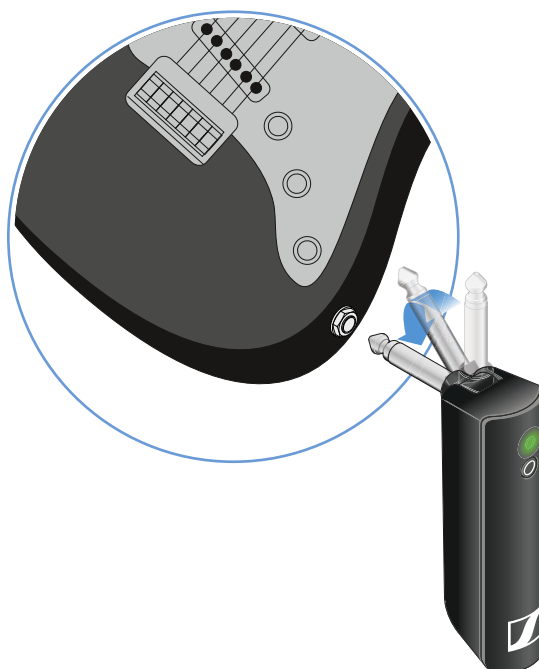

Direct connection

- ▷ Plug the transmitter into the jack socket on your instrument.
- ▷ Align the transmitter so that you can easily see the status LED.

Connection with extension cable

- ▷ Plug the extension cable into the jack socket on your instrument.
- ▷ Plug the transmitter into the jack socket on the extension cable.
- ▷ Insert the transmitter into the belt clip.
- ▷ Fasten the belt clip to the guitar strap or your clothes, for example on your belt or waistband.

Connecting the receiver to an amplifier

- ▷ Plug the receiver's jack plug into the input socket on your amplifier.



Switching on the transmitter and receiver

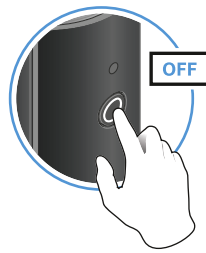

- ▷ Briefly press the button on the transmitter and the button on the receiver.
The status LEDs indicate the charge level for four seconds.
- ▷ During these four seconds, check that the transmitter and receiver are sufficiently charged.
 - > 75%
 - 5% – 75%
 - < 5%

If the status LED remains red, you should charge the rechargeable battery first. If the status LED flashes red, the charge level is too low. You have to charge the rechargeable battery first (see „Charging the rechargeable battery“).

After four seconds, the status LED starts flashing green. The flashing indicates that a wireless connection is being established.

The status LEDs remain green once the transmitter and receiver are connected. If the status LEDs do not remain green, either the charge level is below 15% (see „Checking the charge level during use“) or the transmitter and receiver are not paired (see „Pairing“).

Switching off the transmitter and receiver

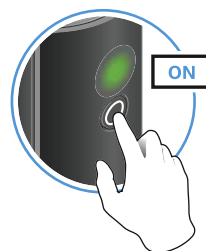

- ▷ Press the button on the transmitter and the button on the receiver until the status LEDs switch off.



Muting the audio signal

When using a set, you can mute the audio signal. The audio signal can then be unmuted.

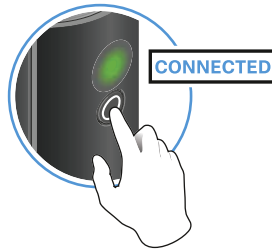

- ▷ To mute the audio signal: Briefly press the button on the transmitter or receiver.
-

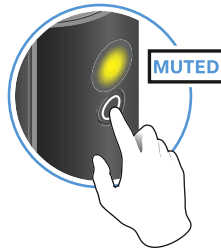

- ▷ To unmute the audio signal: Briefly press the button on the transmitter or receiver.



Checking the charge level during use

The status LED remains green during use as long as the rechargeable battery has sufficient charge. The status LED begins flashing red and green in alternation when the charge level falls below 15%. Once the charge level falls below 5%, the status LED flashes only red.

In addition to the local charge level, the status LED on a transmitter or receiver also provides information about the charge level of the connected transmitter or receiver. This allows you to check the charge levels at any time.



The charge level is below 15%.



The charge level of the **connected** transmitter/receiver is below 15%.



The charge level is below 5%.



The charge level of the **connected** transmitter/receiver is below 5%.





Charging the rechargeable battery

To minimize charging time and monitor the charging status the transmitter or receiver should be switched off before you charge the battery.

However the transmitter or receiver can be charged while in operation.

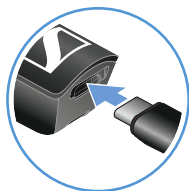

- ▷ Plug the small end of the USB charging cable into the USB port on the transmitter or receiver.
- ▷ Plug the large end of the USB charging cable into the USB port on a conventional USB power supply unit.
- ▷ Plug the USB power supply unit into the wall socket.

The status LED indicates the charge level.

- < 5%
- 5% – 75%
- > 75%
- 100%

Using stickers to label transmission paths

You can use the colored stickers to show which transmitter belongs to which receiver.

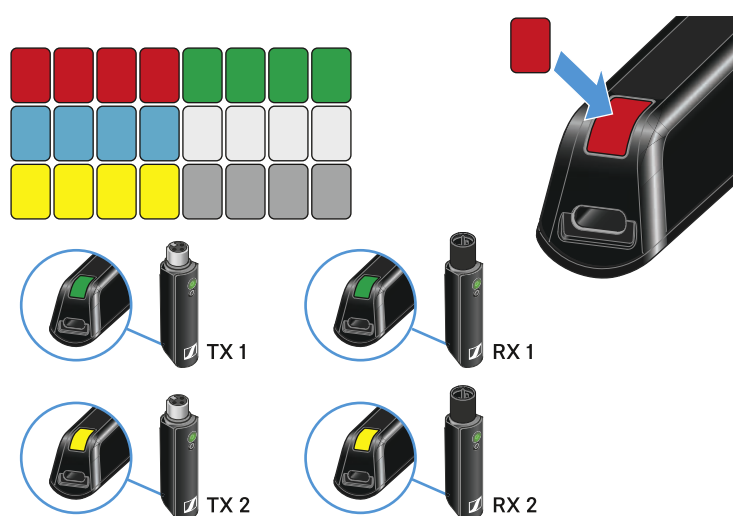



Pairing

The transmitter and the receiver of a set are pre-paired at the factory and therefore ready for immediate use. The wireless connection is established once the transmitter and receiver are switched on and within range of each other.

You can pair up to four transmitters to the receiver.

Please note that you can only use one transmitter at a time. The other paired transmitters must be switched off in the meantime.

- ▷ Make sure that both the transmitter and receiver are switched off.

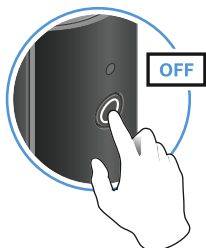

- ▷ Press the button on the transmitter and the button on the receiver until the status LEDs start flashing green and red in alternation.

The status LEDs will remain green once the transmitter and receiver are paired and connected. If the status LEDs do not remain green, the charge level is below 15% (see „Checking the charge level during use“).

Out-of-range monitoring

The status LEDs begin flashing red when the transmitter and receiver are almost out of range.

Correcting faults

If the status LED remains red, a fault has occurred.

- ▷ Unplug any connected USB cables from the UBS port.
- ▷ Switch the transmitter and receiver off and on again.
- ▷ Perform pairing, if necessary.
- ▷ If this does not correct the fault, please contact Sennheiser customer service:
www.sennheiser.com/service-support



PEDALBOARD SET

Package contents



Additional information

- 1** Belt clip for the transmitter
- 2** XSW Digital TX 63: transmitter (6.3 mm jack plug) for connecting to an instrument with a jack socket (6.3 mm) or to the extension cable



- 3** XSW Digital RX Pedal: receiver with built-in tuning device for connecting to a guitar amplifier or mixing console (power supply unit with appropriate country adapter included)
- 4** Charging cable (USB-C to USB-C) for charging the transmitter via the receiver's USB-C port
- 5** Charging cable (USB-A to USB-C) for charging the transmitter using a USB power supply unit
- 6** Extension cable (jack socket to jack plug, 6.3 mm)
- 7** Stickers for labeling transmission paths



Operation

Connecting the transmitter to an instrument

You can connect the transmitter either directly to your instrument or using the extension cable and the belt clip.

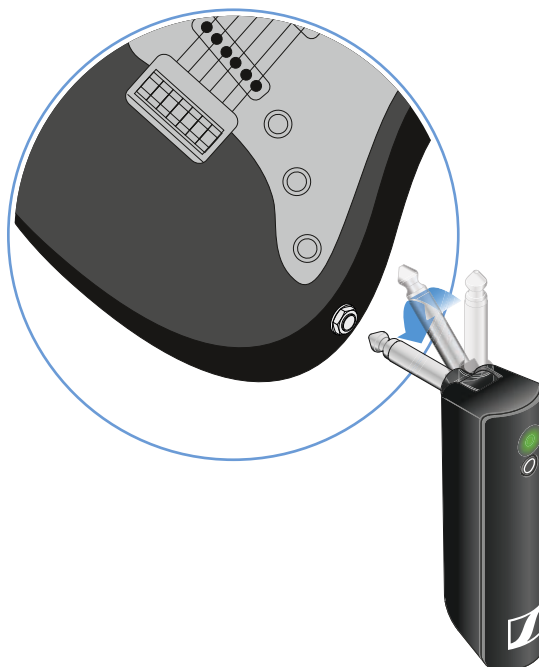

Direct connection

- ▷ Plug the transmitter into the jack socket on your instrument.
- ▷ Align the transmitter so that you can easily see the status LED.

Connection with extension cable

- ▷ Plug the extension cable into the jack socket on your instrument.
- ▷ Plug the transmitter into the jack socket on the extension cable.
- ▷ Insert the transmitter into the belt clip.
- ▷ Fasten the belt clip to the guitar strap or your clothes, for example on your belt or waistband.



Attaching the receiver to the Pedalboard

If necessary, you can attach the receiver to your Pedalboard.

- ▷ Use the provided fastening options on the Pedalboard, for example the adhesive hook-and-loop fastener strips.
- ▷ Alternatively, you can attach the receiver with screws using the threaded holes on the bottom of the receiver (M5 × 10). A drill template is included.

i If using multiple effects devices on your Pedalboard, the receiver must always be the first device in the series, since it is a wireless receiver and therefore does not have an input socket for connecting it with a cable.

Connecting the receiver to an amplifier

You can connect the receiver to an amplifier using a cable with jack plugs (6.3 mm) or connect it to the next device on the Pedalboard.

- ▷ Connect the receiver's output to the input socket on your amplifier or on the next device on the Pedalboard.

i If using multiple effects devices on your Pedalboard, the receiver must always be the first device in the series, since it is a wireless receiver and therefore does not have an input socket for connecting it with a cable.

Connecting the receiver to a mixing console

You can connect the receiver to a mixing console using an XLR cable.

- ▷ Connect the receiver's XLR output to the XLR input of a channel on your mixing console.



Switching on the transmitter and receiver

Switching on the receiver:



- ▷ Connect the receiver to the power supply system. You can use the included power supply unit or power the receiver via the USB port. Battery operation is not possible.
The status LED starts flashing green. The flashing indicates that a wireless connection is being established.

Switching on the transmitter:

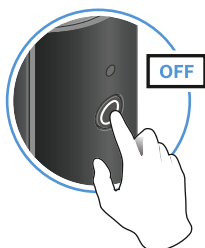

- ▷ Briefly press the button on the transmitter.
The status LED indicates the charge level for four seconds.
- ▷ During these four seconds, check that the transmitter is sufficiently charged.
 - > 75 %
 - 5 % – 75 %
 - < 5 %

If the status LED remains red, you should charge the rechargeable battery first. If the status LED flashes red, the charge level is too low. You must charge the rechargeable battery first (see „Charging the rechargeable battery“).

After four seconds, the status LED starts flashing green. The flashing indicates that a wireless connection is being established.

The status LEDs remain green once the transmitter and receiver are connected. If the status LEDs do not remain green, either the charge level is below 15 % (see „Checking the charge level during use“) or the transmitter and receiver are not paired (see „Pairing“).



Switching off the transmitter and receiver

Switching off the receiver:



- ▷ Disconnect the receiver from the power supply system.

Switching off the transmitter:

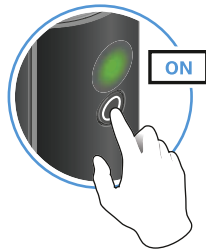

- ▷ Press the button on the transmitter until the status LED switches off.



Muting the audio signal and activating the tuning device

When using a set, you can mute the audio signal. The tuning device is activated while the audio signal is muted.

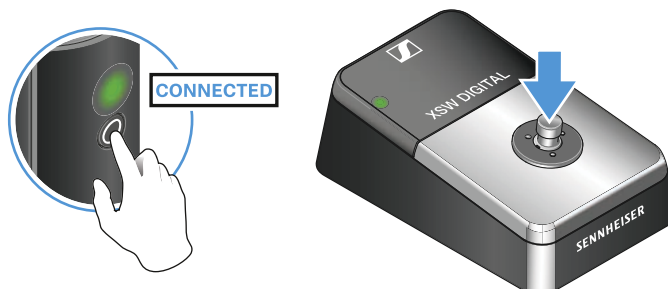

- ▷ To mute the audio signal: Briefly press the button on the transmitter or the pedal switch on the receiver.

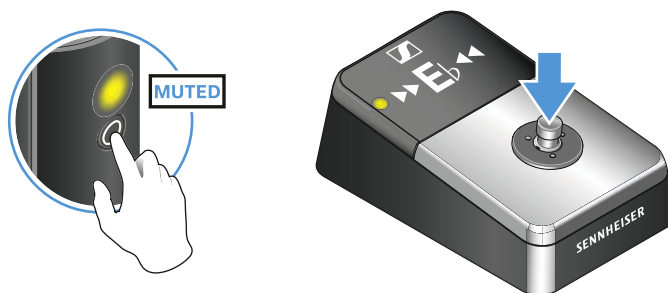

- ▷ To unmute the audio signal: Briefly press the button on the transmitter or the pedal switch on the receiver.



Checking the charge level during use

The status LED remains green during use as long as the transmitter's rechargeable battery has sufficient charge. The status LED begins flashing red and green in alternation when the charge level falls below 15 %. Once the charge level falls below 5 %, the status LED flashes only red.

The status LED on the receiver indicates the charge level of the connected transmitter. This allows you to check the charge level at any time.



The charge level is below 15 %.

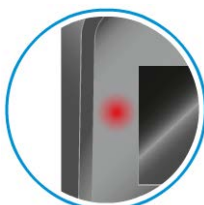

The charge level of the **connected** transmitter is below 15 %.



The charge level is below 5 %.

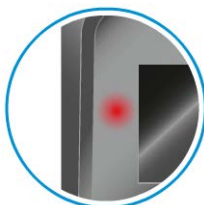

The charge level of the **connected** transmitter is below 5 %.





Charging the rechargeable battery

To minimize charging time and allow you to monitor the charge level, you should switch off the transmitter before charging the battery.

However, the transmitter can also be charged while in operation.

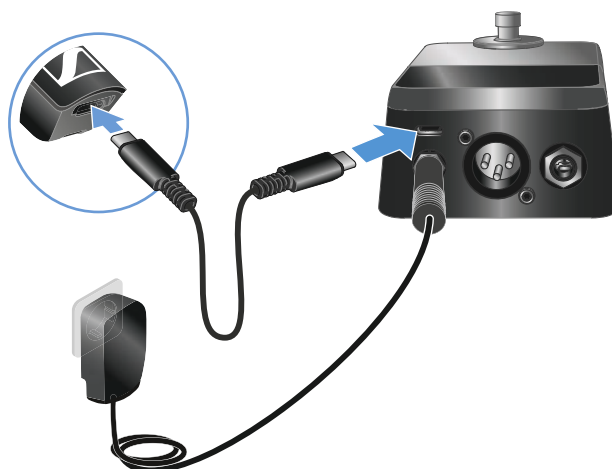

- ▷ Use the charging cable to connect the USB port on the transmitter to the USB port on the receiver.

The status LED indicates the charge level.

- < 5 %
- 5 % – 75 %
- > 75 %
- 100 %

Using stickers to label transmission paths

You can use the colored stickers to show which transmitter belongs to which receiver.

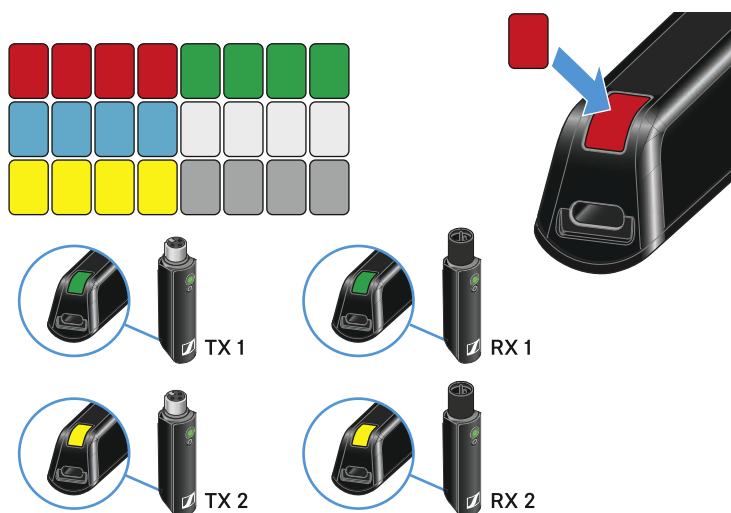



Pairing

The transmitter and the receiver of a set are pre-paired at the factory and therefore ready for immediate use. The wireless connection is established once the transmitter and receiver are switched on and within range of each other.

You can pair up to four transmitters with the receiver. However, you can only use one transmitter with the receiver at a time. The other paired transmitters must be switched off during this time.

- ▷ Make sure that both the transmitter and receiver are switched off.



- ▷ Press and hold the pedal switch on the receiver.
- ▷ Connect the receiver to the power supply system while continuing to hold the pedal switch until a “P” appears on the display. The LED will also begin to flash red and green in alternation.

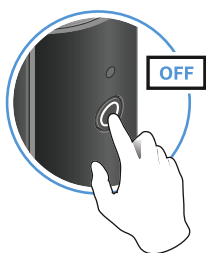

- ▷ Press the button on the transmitter until the status LED starts flashing green and red in alternation. The status LEDs will remain green once the transmitter and receiver are paired and connected. If the status LEDs do not remain green, the charge level is below 15 % (see „Checking the charge level during use“).

Out-of-range monitoring

The status LEDs begin flashing red when the transmitter and receiver are almost out of range.

Correcting faults

If the status LED remains red, a fault has occurred.

- ▷ Unplug any connected USB cables from the UBS port.
- ▷ Switch the transmitter and receiver off and on again.
- ▷ Perform pairing, if necessary.
- ▷ If this does not correct the fault, please contact Sennheiser customer service:
www.sennheiser.com/service-support



PORTABLE INTERVIEW SET

Package contents



Additional information

- 1** Hot shoe adapter for the receiver
- 2** XSW Digital TX XLR: transmitter (female XLR socket) for connecting to a microphone with an XLR socket



- 3** XSW Digital RX 35: receiver (3.5 mm jack socket) for connecting to the camera cable



- 4** Charging cable (USB-A to USB-C) for charging the transmitter and receiver
- 5** Camera cable (jack plug to jack plug, 3.5 mm) for connecting to the camera
- 6** Stickers for labeling transmission paths



Operation

Connecting the transmitter to the microphone



- ▷ Plug the transmitter into the XLR socket on your microphone.

Connecting the receiver to the camera



- ▷ Plug the camera cable's screw-on jack plug into the jack socket on the receiver.
- ▷ Lock the jack plug by screwing down the coupling ring.
If the jack plug is not firmly locked, crackling noise can appear in the audio signal.
- ▷ Insert the receiver into the hot shoe adapter.
- ▷ Slide the hot shoe adapter onto your camera.
- ▷ Plug the camera cable's simple jack plug into the jack socket on your camera.



Holding the microphone



- ▷ Grip the microphone only by the handle.
- ▷ Hold the microphone 5 to 10 cm in front of your mouth.
- ▷ Do not grab the transmitter. The range may decrease if the transmitter is covered.
- ▷ Do not touch the microphone basket. The sound may be distorted if the microphone basket is covered.

Switching on the transmitter and receiver

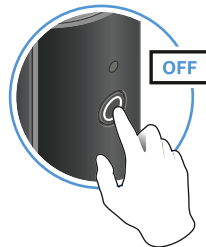

- ▷ Briefly press the button on the transmitter and the button on the receiver.
The status LEDs indicate the charge level for four seconds.
- ▷ During these four seconds, check that the transmitter and receiver are sufficiently charged.
 - > 75%
 - 5% – 75%
 - < 5%

If the status LED remains red, you should charge the rechargeable battery first. If the status LED flashes red, the charge level is too low. You have to charge the rechargeable battery first (see „Charging the rechargeable battery“).

After four seconds, the status LED starts flashing green. The flashing indicates that a wireless connection is being established.



The status LEDs remain green once the transmitter and receiver are connected. If the status LEDs do not remain green, either the charge level is below 15% (see „Checking the charge level during use“) or the transmitter and receiver are not paired (see „Pairing“).

Switching off the transmitter and receiver

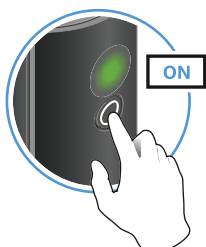

- ▷ Press the button on the transmitter and the button on the receiver until the status LEDs switch off.

Adjusting the input level on the camera

Once you have connected the receiver to the camera and switched it on, you have to adjust the input level on the camera.

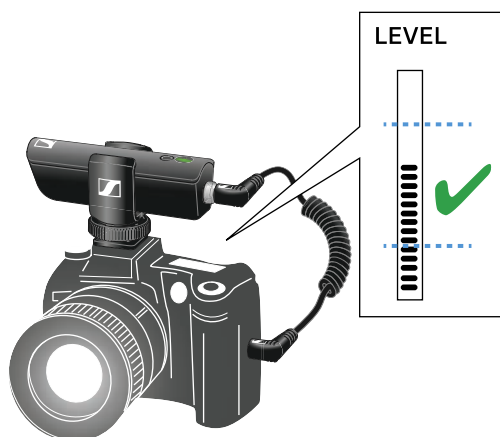

- ▷ If the camera has automatic gain control (AGC), you should disable this function.
- ▷ Set the input level in the camera's menu so that the audio signal does not overload the input.
- ▷ During recording, regularly check the input level on the camera to make sure that the audio signal is not overloading.



Muting the audio signal

When using a set, you can mute the audio signal. The audio signal can then be unmuted.

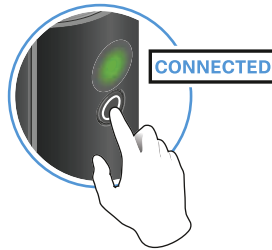

- ▷ To mute the audio signal: Briefly press the button on the transmitter or receiver.
-



- ▷ To unmute the audio signal: Briefly press the button on the transmitter or receiver.



Checking the charge level during use

The status LED remains green during use as long as the rechargeable battery has sufficient charge. The status LED begins flashing red and green in alternation when the charge level falls below 15%. Once the charge level falls below 5%, the status LED flashes only red.

In addition to the local charge level, the status LED on a transmitter or receiver also provides information about the charge level of the connected transmitter or receiver. This allows you to check the charge levels at any time.



The charge level is below 15%.



The charge level of the **connected** transmitter/receiver is below 15%.



The charge level is below 5%.



The charge level of the **connected** transmitter/receiver is below 5%.





Charging the rechargeable battery

To minimize charging time and monitor the charging status the transmitter or receiver should be switched off before you charge the battery.

However the transmitter or receiver can be charged while in operation.

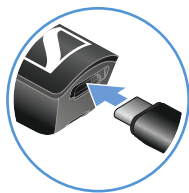

- ▷ Plug the small end of the USB charging cable into the USB port on the transmitter or receiver.
- ▷ Plug the large end of the USB charging cable into the USB port on a conventional USB power supply unit.
- ▷ Plug the USB power supply unit into the wall socket.

The status LED indicates the charge level.

- < 5%
- 5% – 75%
- > 75%
- 100%

Using stickers to label transmission paths

You can use the colored stickers to show which transmitter belongs to which receiver.

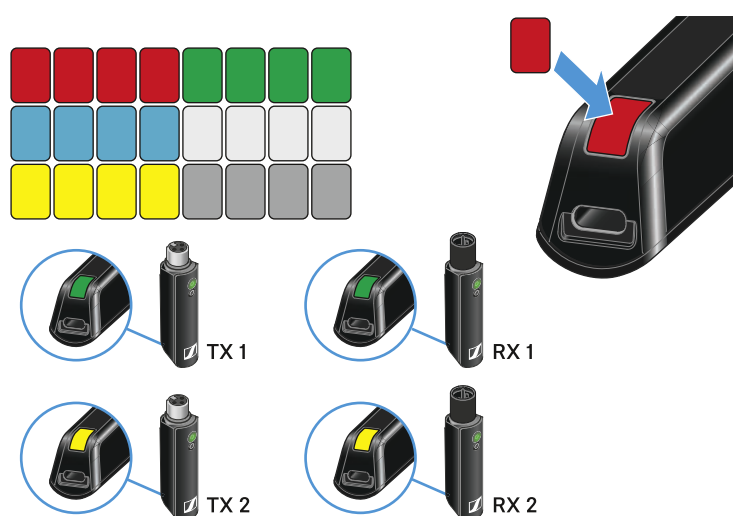



Pairing

The transmitter and the receiver of a set are pre-paired at the factory and therefore ready for immediate use. The wireless connection is established once the transmitter and receiver are switched on and within range of each other.

You can pair up to four transmitters to the receiver.

Please note that you can only use one transmitter at a time. The other paired transmitters must be switched off in the meantime.

- ▷ Make sure that both the transmitter and receiver are switched off.

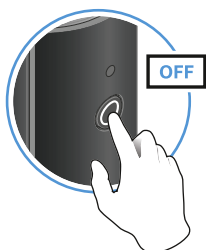

- ▷ Press the button on the transmitter and the button on the receiver until the status LEDs start flashing green and red in alternation.

The status LEDs will remain green once the transmitter and receiver are paired and connected. If the status LEDs do not remain green, the charge level is below 15% (see „Checking the charge level during use“).

Out-of-range monitoring

The status LEDs begin flashing red when the transmitter and receiver are almost out of range.

Correcting faults

If the status LED remains red, a fault has occurred.

- ▷ Unplug any connected USB cables from the USB port.
- ▷ Switch the transmitter and receiver off and on again.
- ▷ Perform pairing, if necessary.
- ▷ If this does not correct the fault, please contact Sennheiser customer service:
www.sennheiser.com/service-support



PORTABLE LAVALIER SET

Package contents



Additional information

- 1** Belt clip for the transmitter
- 2** Hot shoe adapter for the receiver
- 3** XSW Digital TX 35: transmitter (3.5 mm jack socket) for connecting to the clip-on microphone



- 4** XSW Digital RX 35: receiver (3.5 mm jack socket) for connecting to the camera cable



- 5** Charging cable (USB-A to USB-C) for charging the transmitter and receiver
- 6** ME 2-2: clip-on microphone
- 7** Camera cable (jack plug to jack plug, 3.5 mm) for connecting to the camera
- 8** Stickers for labeling transmission paths



Operation

Connecting the clip-on microphone to the transmitter

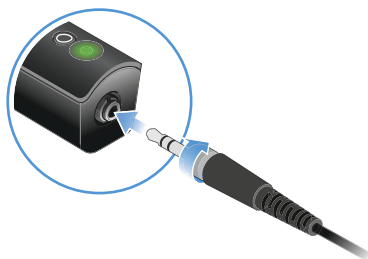

- ▷ Plug the clip-on microphone's screw-on jack plug into the jack socket on the transmitter.
- ▷ Lock the jack plug by screwing down the coupling ring.
If the jack plug is not firmly locked, crackling noise can appear in the audio signal.
- ▷ Insert the transmitter into the belt clip.
- ▷ Fasten the belt clip to your clothes, for example on your belt or waistband.

Attaching the clip-on microphone

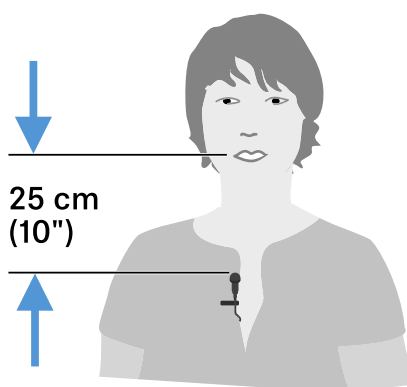

- ▷ Fasten the clip-on microphone to your clothes, for example on your collar or lapel.
- ▷ The distance to your mouth should be about 25 cm. The distance affects the sensitivity of the clip-on microphone. Reduce the distance if you are speaking at a low volume, and increase it when speaking loudly.



Connecting the receiver to the camera



- ▷ Plug the camera cable's screw-on jack plug into the jack socket on the receiver.
- ▷ Lock the jack plug by screwing down the coupling ring.
If the jack plug is not firmly locked, crackling noise can appear in the audio signal.
- ▷ Insert the receiver into the hot shoe adapter.
- ▷ Slide the hot shoe adapter onto your camera.
- ▷ Plug the camera cable's simple jack plug into the jack socket on your camera.

Switching on the transmitter and receiver

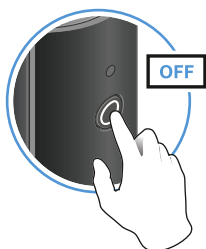

- ▷ Briefly press the button on the transmitter and the button on the receiver.
The status LEDs indicate the charge level for four seconds.
- ▷ During these four seconds, check that the transmitter and receiver are sufficiently charged.
 - > 75%
 - 5% – 75%
 - < 5%

If the status LED remains red, you should charge the rechargeable bat-



tery first. If the status LED flashes red, the charge level is too low. You have to charge the rechargeable battery first (see „Charging the rechargeable battery“).

After four seconds, the status LED starts flashing green. The flashing indicates that a wireless connection is being established.

The status LEDs remain green once the transmitter and receiver are connected. If the status LEDs do not remain green, either the charge level is below 15% (see „Checking the charge level during use“) or the transmitter and receiver are not paired (see „Pairing“).

Switching off the transmitter and receiver

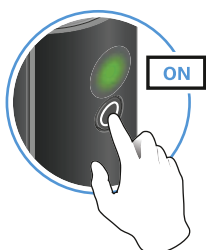

- ▷ Press the button on the transmitter and the button on the receiver until the status LEDs switch off.

Adjusting the input level on the camera

Once you have connected the receiver to the camera and switched it on, you have to adjust the input level on the camera.

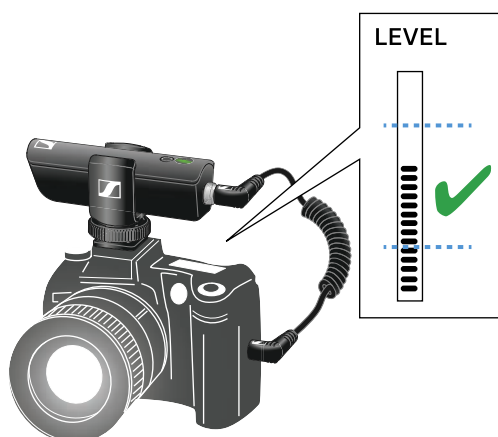

- ▷ If the camera has automatic gain control (AGC), you should disable this function.
- ▷ Set the input level in the camera's menu so that the audio signal does not overload the input.
- ▷ During recording, regularly check the input level on the camera to make sure that the audio signal is not overloading.



Muting the audio signal

When using a set, you can mute the audio signal. The audio signal can then be unmuted.

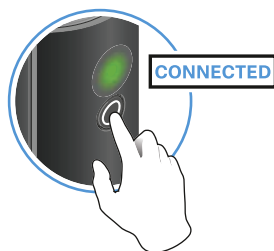

- ▷ To mute the audio signal: Briefly press the button on the transmitter or receiver.
-

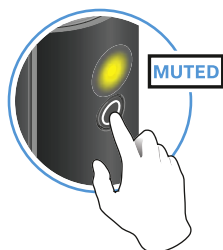

- ▷ To unmute the audio signal: Briefly press the button on the transmitter or receiver.



Checking the charge level during use

The status LED remains green during use as long as the rechargeable battery has sufficient charge. The status LED begins flashing red and green in alternation when the charge level falls below 15%. Once the charge level falls below 5%, the status LED flashes only red.

In addition to the local charge level, the status LED on a transmitter or receiver also provides information about the charge level of the connected transmitter or receiver. This allows you to check the charge levels at any time.



The charge level is below 15%.



The charge level of the **connected** transmitter/receiver is below 15%.



The charge level is below 5%.



The charge level of the **connected** transmitter/receiver is below 5%.





Charging the rechargeable battery

To minimize charging time and monitor the charging status the transmitter or receiver should be switched off before you charge the battery.

However the transmitter or receiver can be charged while in operation.

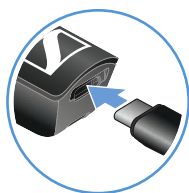

- ▷ Plug the small end of the USB charging cable into the USB port on the transmitter or receiver.
- ▷ Plug the large end of the USB charging cable into the USB port on a conventional USB power supply unit.
- ▷ Plug the USB power supply unit into the wall socket.

The status LED indicates the charge level.

- < 5%
- 5% – 75%
- > 75%
- 100%

Using stickers to label transmission paths

You can use the colored stickers to show which transmitter belongs to which receiver.

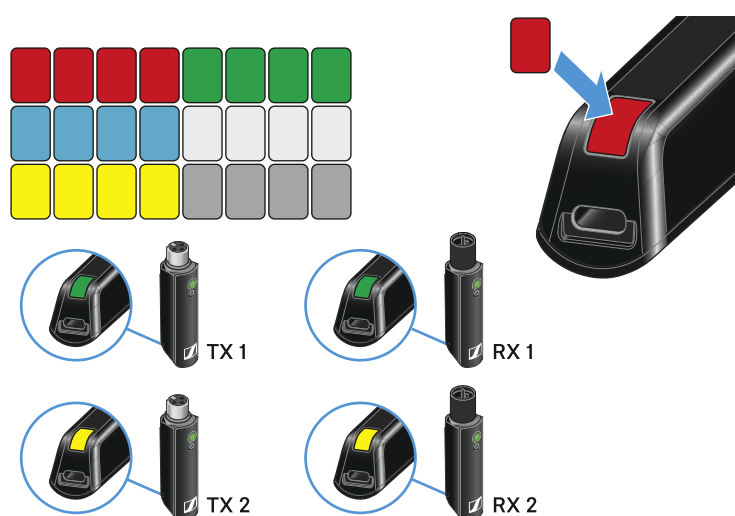



Pairing

The transmitter and the receiver of a set are pre-paired at the factory and therefore ready for immediate use. The wireless connection is established once the transmitter and receiver are switched on and within range of each other.

You can pair up to four transmitters to the receiver.

Please note that you can only use one transmitter at a time. The other paired transmitters must be switched off in the meantime.

- ▷ Make sure that both the transmitter and receiver are switched off.

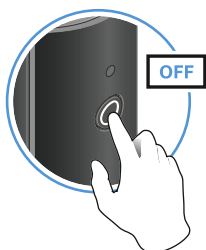

- ▷ Press the button on the transmitter and the button on the receiver until the status LEDs start flashing green and red in alternation.

The status LEDs will remain green once the transmitter and receiver are paired and connected. If the status LEDs do not remain green, the charge level is below 15% (see „Checking the charge level during use“).

Out-of-range monitoring

The status LEDs begin flashing red when the transmitter and receiver are almost out of range.

Correcting faults

If the status LED remains red, a fault has occurred.

- ▷ Unplug any connected USB cables from the USB port.
- ▷ Switch the transmitter and receiver off and on again.
- ▷ Perform pairing, if necessary.
- ▷ If this does not correct the fault, please contact Sennheiser customer service:
www.sennheiser.com/service-support



PORTABLE ENG SET

Package contents

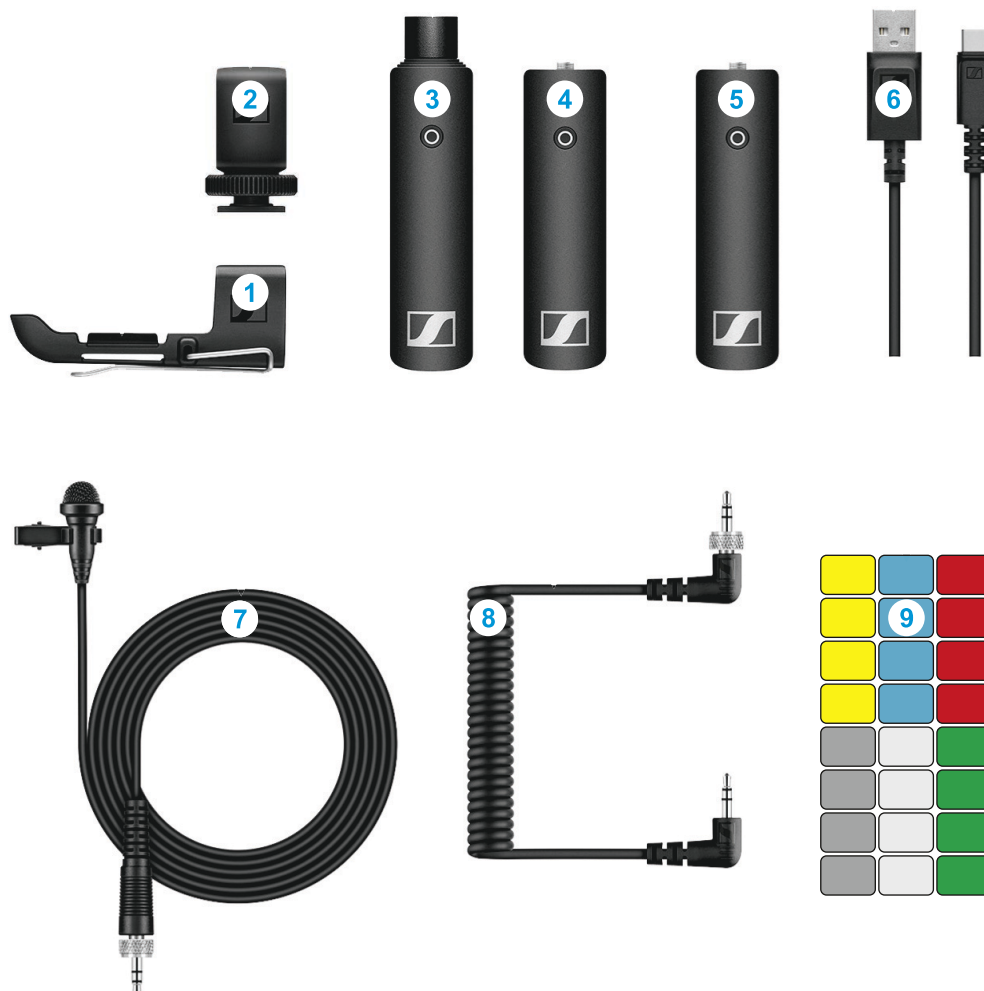

Additional information

- 1** Belt clip for the transmitter
- 2** Hot shoe adapter for the receiver
- 3** XSW Digital TX XLR: transmitter (female XLR socket) for connecting to a microphone



- 4** XSW Digital TX 35: transmitter (3.5 mm jack socket) for connecting to the clip-on microphone





- 5 XSW Digital RX 35: receiver (3.5 mm jack socket) for connecting to the camera cable



- 6 Charging cable (USB-A to USB-C) for charging the transmitter and receiver
- 7 ME 2-2: clip-on microphone
- 8 Camera cable (jack plug to jack plug, 3.5 mm) for connecting to the camera
- 9 Stickers for labeling transmission paths

Operation

Connecting the transmitter to the microphone



- ▷ Plug the transmitter into the XLR socket on your microphone.



Connecting the clip-on microphone to the transmitter

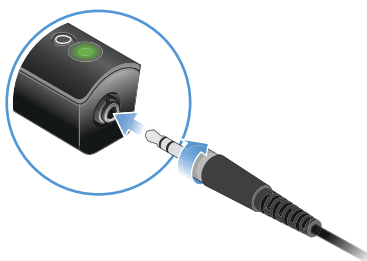

- ▷ Plug the clip-on microphone's screw-on jack plug into the jack socket on the transmitter.
- ▷ Lock the jack plug by screwing down the coupling ring.
If the jack plug is not firmly locked, crackling noise can appear in the audio signal.
- ▷ Insert the transmitter into the belt clip.
- ▷ Fasten the belt clip to your clothes, for example on your belt or waistband.

Attaching the clip-on microphone

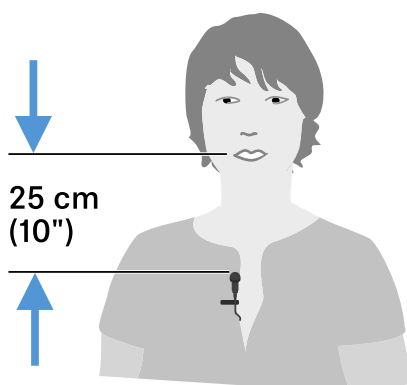

- ▷ Fasten the clip-on microphone to your clothes, for example on your collar or lapel.
- ▷ The distance to your mouth should be about 25 cm. The distance affects the sensitivity of the clip-on microphone. Reduce the distance if you are speaking at a low volume, and increase it when speaking loudly.



Connecting the receiver to the camera



- ▷ Plug the camera cable's screw-on jack plug into the jack socket on the receiver.
- ▷ Lock the jack plug by screwing down the coupling ring.
If the jack plug is not firmly locked, crackling noise can appear in the audio signal.
- ▷ Insert the receiver into the hot shoe adapter.
- ▷ Slide the hot shoe adapter onto your camera.
- ▷ Plug the camera cable's simple jack plug into the jack socket on your camera.



Switching on the transmitter and receiver

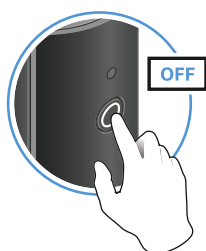

- ▷ Briefly press the button on the transmitter and the button on the receiver.

The status LEDs indicate the charge level for four seconds.

- ▷ During these four seconds, check that the transmitter and receiver are sufficiently charged.

- > 75%
- 5% – 75%
- < 5%

If the status LED remains red, you should charge the rechargeable battery first. If the status LED flashes red, the charge level is too low. You have to charge the rechargeable battery first (see „Charging the rechargeable battery“).

After four seconds, the status LED starts flashing green. The flashing indicates that a wireless connection is being established.

The status LEDs remain green once the transmitter and receiver are connected. If the status LEDs do not remain green, either the charge level is below 15% (see „Checking the charge level during use“) or the transmitter and receiver are not paired (see „Pairing“).

Switching off the transmitter and receiver

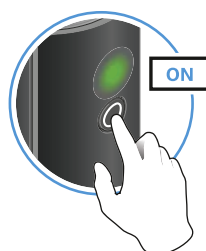

- ▷ Press the button on the transmitter and the button on the receiver until the status LEDs switch off.



Adjusting the input level on the camera

Once you have connected the receiver to the camera and switched it on, you have to adjust the input level on the camera.

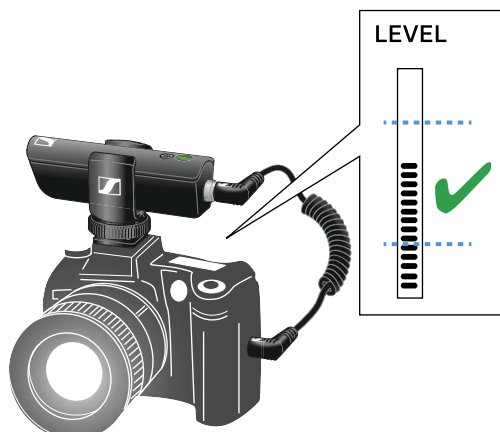

- ▷ If the camera has automatic gain control (AGC), you should disable this function.
- ▷ Set the input level in the camera's menu so that the audio signal does not overload the input.
- ▷ During recording, regularly check the input level on the camera to make sure that the audio signal is not overloading.

Muting the audio signal

When using a set, you can mute the audio signal. The audio signal can then be unmuted.

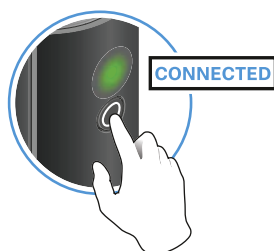

- ▷ To mute the audio signal: Briefly press the button on the transmitter or receiver.

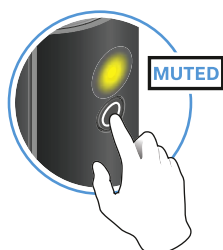

- ▷ To unmute the audio signal: Briefly press the button on the transmitter or receiver.



Checking the charge level during use

The status LED remains green during use as long as the rechargeable battery has sufficient charge. The status LED begins flashing red and green in alternation when the charge level falls below 15%. Once the charge level falls below 5%, the status LED flashes only red.

In addition to the local charge level, the status LED on a transmitter or receiver also provides information about the charge level of the connected transmitter or receiver. This allows you to check the charge levels at any time.



The charge level is below 15%.



The charge level of the **connected** transmitter/receiver is below 15%.



The charge level is below 5%.



The charge level of the **connected** transmitter/receiver is below 5%.





Charging the rechargeable battery

To minimize charging time and monitor the charging status the transmitter or receiver should be switched off before you charge the battery.

However the transmitter or receiver can be charged while in operation.

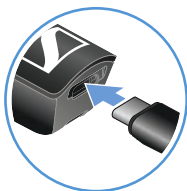

- ▷ Plug the small end of the USB charging cable into the USB port on the transmitter or receiver.
- ▷ Plug the large end of the USB charging cable into the USB port on a conventional USB power supply unit.
- ▷ Plug the USB power supply unit into the wall socket.

The status LED indicates the charge level.

- < 5%
- 5% – 75%
- > 75%
- 100%

Using stickers to label transmission paths

You can use the colored stickers to show which transmitter belongs to which receiver.

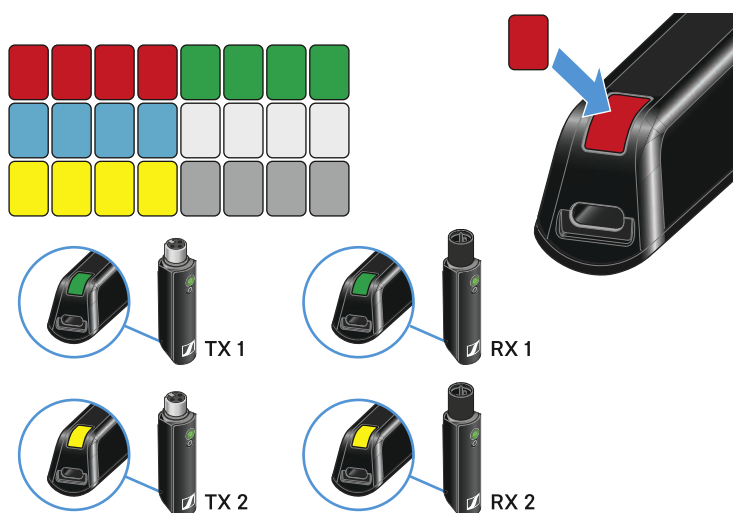



Pairing

The transmitter and the receiver of a set are pre-paired at the factory and therefore ready for immediate use. The wireless connection is established once the transmitter and receiver are switched on and within range of each other.

You can pair up to four transmitters to the receiver.

Please note that you can only use one transmitter at a time. The other paired transmitters must be switched off in the meantime.

- ▷ Make sure that both the transmitter and receiver are switched off.

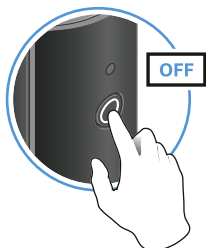

- ▷ Press the button on the transmitter and the button on the receiver until the status LEDs start flashing green and red in alternation.

The status LEDs will remain green once the transmitter and receiver are paired and connected. If the status LEDs do not remain green, the charge level is below 15% (see „Checking the charge level during use“).

Out-of-range monitoring

The status LEDs begin flashing red when the transmitter and receiver are almost out of range.

Correcting faults

If the status LED remains red, a fault has occurred.

- ▷ Unplug any connected USB cables from the UBS port.
- ▷ Switch the transmitter and receiver off and on again.
- ▷ Perform pairing, if necessary.
- ▷ If this does not correct the fault, please contact Sennheiser customer service:
www.sennheiser.com/service-support



PORTABLE BASE SET

Package contents



Additional information

- 1** Belt clip for the transmitter
- 2** Hot shoe adapter for the receiver
- 3** XSW Digital TX 35: transmitter (3.5 mm jack socket) for connecting to a microphone with a jack plug (3.5 mm)



- 4** XSW Digital RX 35: receiver (3.5 mm jack socket) for connecting to the camera cable



- 5** Charging cable (USB-A to USB-C) for charging the transmitter and receiver
- 6** Camera cable (jack plug to jack plug, 3.5 mm) for connecting to the camera
- 7** Stickers for labeling transmission paths



Operation

Connecting the microphone to the transmitter

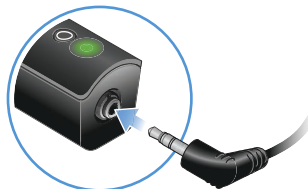

- ▷ Plug your microphone's jack plug into the jack socket on the transmitter.
- ▷ Insert the transmitter into the belt clip.
- ▷ Fasten the belt clip to your clothes, for example on your belt or waistband.

Connecting the receiver to the camera



- ▷ Plug the camera cable's screw-on jack plug into the jack socket on the receiver.
- ▷ Lock the jack plug by screwing down the coupling ring.
If the jack plug is not firmly locked, crackling noise can appear in the audio signal.
- ▷ Insert the receiver into the hot shoe adapter.
- ▷ Slide the hot shoe adapter onto your camera.
- ▷ Plug the camera cable's simple jack plug into the jack socket on your camera.



Switching on the transmitter and receiver

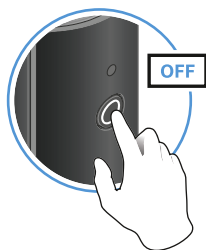

- ▷ Briefly press the button on the transmitter and the button on the receiver.

The status LEDs indicate the charge level for four seconds.

- ▷ During these four seconds, check that the transmitter and receiver are sufficiently charged.

- > 75%
- 5% – 75%
- < 5%

If the status LED remains red, you should charge the rechargeable battery first. If the status LED flashes red, the charge level is too low. You have to charge the rechargeable battery first (see „Charging the rechargeable battery“).

After four seconds, the status LED starts flashing green. The flashing indicates that a wireless connection is being established.

The status LEDs remain green once the transmitter and receiver are connected. If the status LEDs do not remain green, either the charge level is below 15% (see „Checking the charge level during use“) or the transmitter and receiver are not paired (see „Pairing“).

Switching off the transmitter and receiver

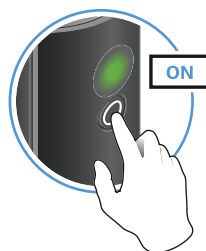

- ▷ Press the button on the transmitter and the button on the receiver until the status LEDs switch off.



Adjusting the input level on the camera

Once you have connected the receiver to the camera and switched it on, you have to adjust the input level on the camera.

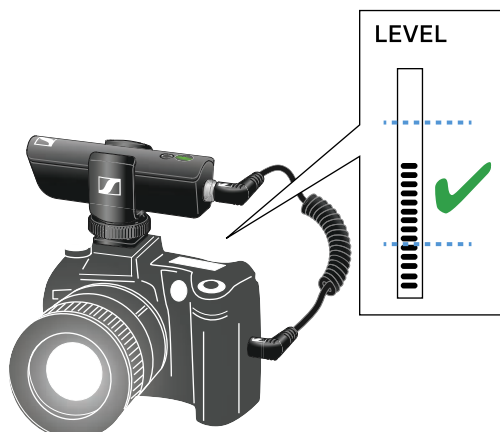

- ▷ If the camera has automatic gain control (AGC), you should disable this function.
- ▷ Set the input level in the camera's menu so that the audio signal does not overload the input.
- ▷ During recording, regularly check the input level on the camera to make sure that the audio signal is not overloading.

Muting the audio signal

When using a set, you can mute the audio signal. The audio signal can then be unmuted.

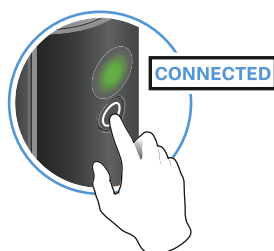

- ▷ To mute the audio signal: Briefly press the button on the transmitter or receiver.

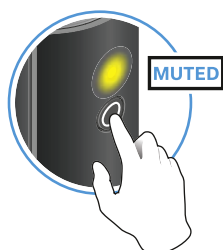

- ▷ To unmute the audio signal: Briefly press the button on the transmitter or receiver.



Checking the charge level during use

The status LED remains green during use as long as the rechargeable battery has sufficient charge. The status LED begins flashing red and green in alternation when the charge level falls below 15%. Once the charge level falls below 5%, the status LED flashes only red.

In addition to the local charge level, the status LED on a transmitter or receiver also provides information about the charge level of the connected transmitter or receiver. This allows you to check the charge levels at any time.



The charge level is below 15%.



The charge level of the **connected** transmitter/receiver is below 15%.



The charge level is below 5%.



The charge level of the **connected** transmitter/receiver is below 5%.





Charging the rechargeable battery

To minimize charging time and monitor the charging status the transmitter or receiver should be switched off before you charge the battery.

However the transmitter or receiver can be charged while in operation.

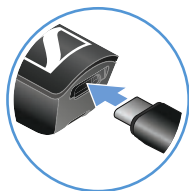

- ▷ Plug the small end of the USB charging cable into the USB port on the transmitter or receiver.
- ▷ Plug the large end of the USB charging cable into the USB port on a conventional USB power supply unit.
- ▷ Plug the USB power supply unit into the wall socket.

The status LED indicates the charge level.

- < 5%
- 5% – 75%
- > 75%
- 100%

Using stickers to label transmission paths

You can use the colored stickers to show which transmitter belongs to which receiver.

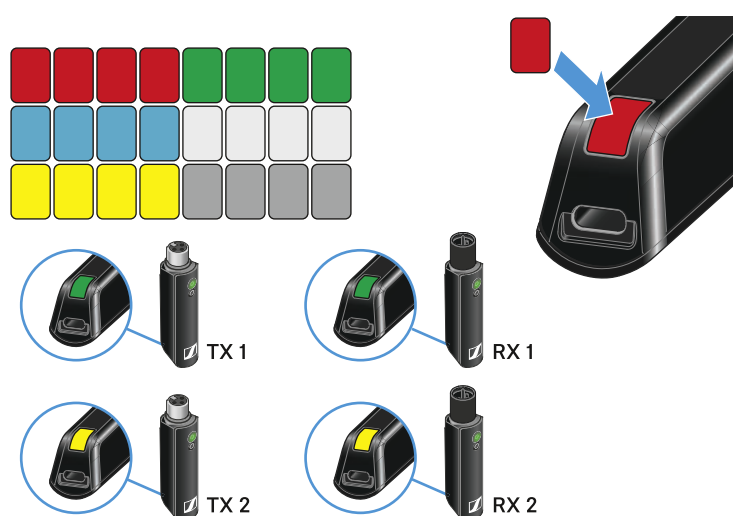



Pairing

The transmitter and the receiver of a set are pre-paired at the factory and therefore ready for immediate use. The wireless connection is established once the transmitter and receiver are switched on and within range of each other.

You can pair up to four transmitters to the receiver.

Please note that you can only use one transmitter at a time. The other paired transmitters must be switched off in the meantime.

- ▷ Make sure that both the transmitter and receiver are switched off.

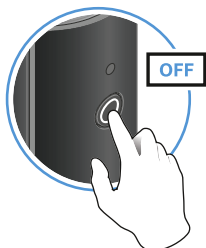

- ▷ Press the button on the transmitter and the button on the receiver until the status LEDs start flashing green and red in alternation.

The status LEDs will remain green once the transmitter and receiver are paired and connected. If the status LEDs do not remain green, the charge level is below 15% (see „Checking the charge level during use“).

Out-of-range monitoring

The status LEDs begin flashing red when the transmitter and receiver are almost out of range.

Correcting faults

If the status LED remains red, a fault has occurred.

- ▷ Unplug any connected USB cables from the USB port.
- ▷ Switch the transmitter and receiver off and on again.
- ▷ Perform pairing, if necessary.
- ▷ If this does not correct the fault, please contact Sennheiser customer service:
www.sennheiser.com/service-support